

Soffit Slab



fire stopping
within the soffit

key features

- » Provides fire stopping within the soffit at the party wall junction
- » Excellent thermal and acoustic properties
- » One size fits most roof pitches and soffit dimensions
- » Manufactured from foil faced mineral wool

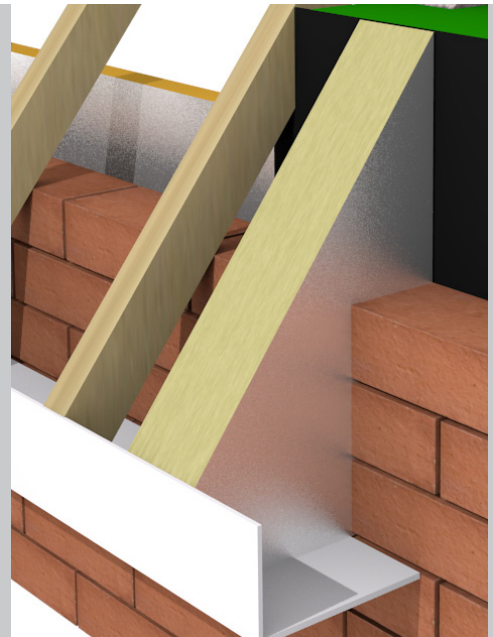

Application

The ARC Soffit Slab is designed to fill the void within the soffit, providing a fire, thermal and acoustic barrier between dwellings. The barrier is manufactured from rockfibre mineral wool, with a foil facing to ensure an effective smoke barrier is created. An exact fit can be created to form an effective barrier at this junction.

Installation

ARC Soffit Slab is easily installed. Simply cut on site to the required size, ensuring no gaps remain around the edges of the barrier once fitted within the soffit.

Fire Properties

ARC Soffit Slab complies with building regulations for fire stopping at the pitched roof party wall detail, as well as NHBC 7.2.16.

Standards

ARC Soffit Slab is manufactured using rockfibre mineral wool which achieves a fire classification of Euroclass A1 as defined in BS EN 13501-1, and conforms to BS EN 13162 and EN16001 Energy Management Systems.

ARC's rockfibre mineral wool insulation has a thermal conductivity of 0.037W/mK.

Don't take our word for it, see our certification...



Certificate Number 19310
ISO 9001, ISO 14001

Storage and Packaging

ARC Soffit Slabs are supplied in polythene packs which are designed for transporting and protecting the products. It is not recommended that the packs are stored in direct sunlight. When storing the barriers for longer periods of time it is recommended that the product should be stored indoors, or under cover.

Environment

No CFCs or HCFCs are involved in the manufacturing process of ARC's rockfibre mineral wool insulation. The material presents no known threat to the environment and is classed as ODP and GWP zero.

ARC Soffit Slab has a Green Guide rating of A+.

Health and Safety

ARC Building Solutions has an approved Health and Safety Policy and is committed to working and supplying products safely. ARC's rockfibre mineral wool is not classed as a possible human carcinogen. We have assessed products as required by Substances Hazardous to Health Regulations (COSHH). An ARC COSHH data sheet is available and can be downloaded from ARC's website.

Standard Dimensions & Packaging Specification

Product Code	Dimensions	Pack Qty	Packs per Pallet
SSL600/450	450 x 600 x 100mm	8	10